

**META Deck-mounted tub mixer, with hand shower set for deck-mounted tub installation - Chrome**

META

27 632 661 Product version from 7/1/2023



- Spout: Round aerated stream
- Water flow rate limited to max. 6.2 gpm
- Hand-held shower: COMPACT RAIN, flow rate max. 1.8 gpm (at 3 bar)
- Hand shower set with anti-scale technology
- Integrated diverter
- 8-3/4" Projection
- Total height 12-1/2"
- Height to aerator/spout outlet 8-1/2"
- Spout hole diameter 1-3/8"
- Hole diameter single-lever mixer 1-3/8"
- Hole diameter for hand shower set 1-1/4"
- 2-1/8" diameter flange for spout
- Mixer with flange Ø 2-1/8"
- Hand shower set with flange Ø 2-3/8"
- Metal shower hose 68-7/8" with anti-twist device

Internal backflow preventer.

NOTE: Local building codes may require the use of an anti-scald device. Please refer to remote pressure balance valve (35 914 970 90)

	Chrome	27 632 661-00
	Brushed Platinum	27 632 661-06
	Dark Chrome	27 632 661-19
	Light Gold (PVD)	27 632 661-26
	Brushed Light Gold (PVD)	27 632 661-27
	Matte Black	27 632 661-33
	Brushed Dark Brass (PVD)	27 632 661-39
	Brushed Bronze (PVD)	27 632 661-42
	Brushed Chrome	27 632 661-93
	Brushed Dark Platinum	27 632 661-99

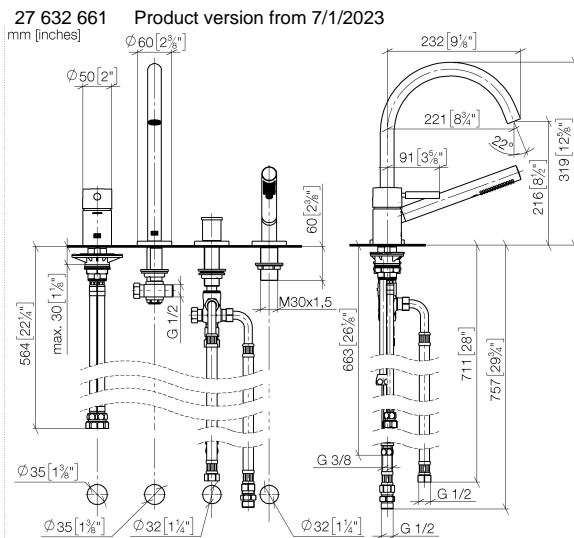

**Flow rate chart**

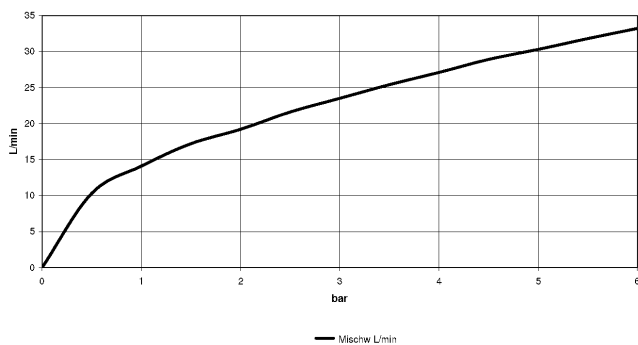

**Codes & Standards**

ASME A112.18.1	California Energy Commission (CEC)	cUPC	DIN 4109
EN 1717	ISO 3822	Scottish Water Byelaws	UK Water Supply Regulations

**Ü-Zeichen**



META Deck-mounted tub mixer, with hand shower set for deck-mounted tub installation - Chrome

META

---

27 632 661 Product version from 7/1/2023

Certificates and sustainability

---

LGA\_38

WRAS\_2207

IAPMO\_4976

Belgaqua\_21-026-2 Belgaqua\_25-341-2

**META Deck-mounted tub mixer, with hand shower set for deck-mounted tub installation - Chrome**

META

27 632 661 Product version from 7/1/2023

Parts for other finishes can be found here: [Brushed Platinum](#)

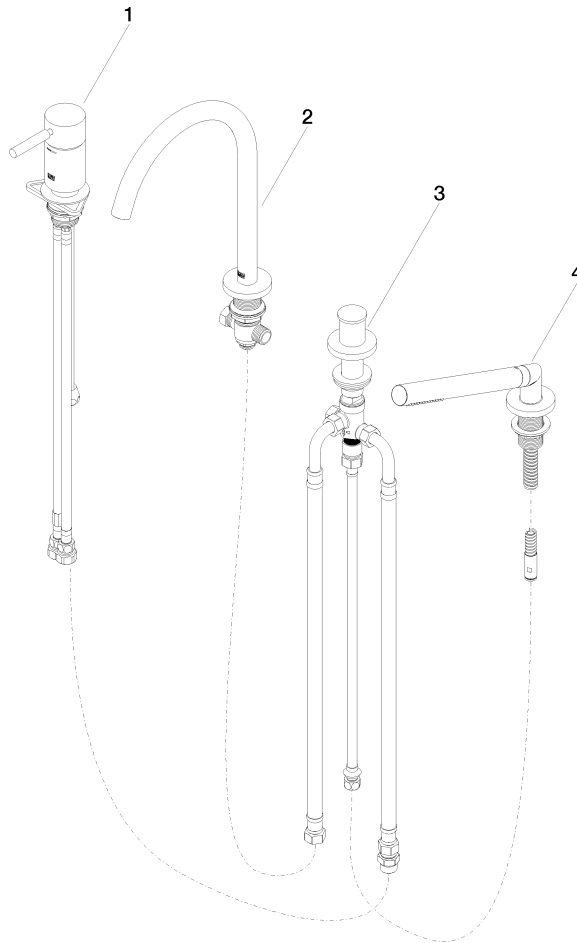

**Spare parts list**

Number	Item Number	Designation	Number of units	Lead time
4	27 702 660-00	META Hand shower set for deck-mounted tub installation - Chrome	1.00	10
2	13 512 661-00	spout	1.00	60
1	29 300 660-00	META Single-lever tub mixer for deck-mounted tub installation - Chrome	1.00	10
3	29 140 660-00	META Two-way diverter for deck-mounted tub installation - Chrome	1.00	10