

**CL.1 Volume Control clockwise-closing 3/4" - Chrome**







CL.1

36 608 705 Product version up to 10/14/2020



- Flange 2-3/8" x 2-3/8"
- without marking
- Ceramic disc cartridge  
**(ADA)**

(ADA)

	Chrome	36 608 705-00
	Brushed Platinum	36 608 705-06
	Dark Chrome	36 608 705-19
	Brushed Champagne (22kt Gold)	36 608 705-46
	Champagne (22kt Gold)	36 608 705-47
	Brushed Dark Platinum	36 608 705-99

**Required article**



- Rough for volume control 3/4" -** 35 608 970-90  
 •Max. rough in depth 5-7/8" 0010  
 •Min. rough in depth 4-1/8"

36 608 705 Product version up to 10/14/2020

mm [inches]



**Flow rate chart**

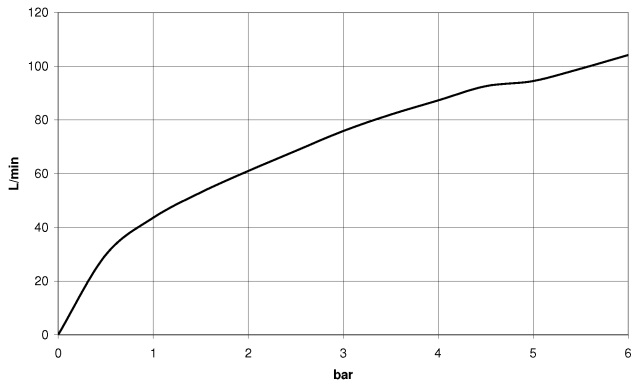

**Codes & Standards**

ADA

ASME A112.18.1

cUPC

Scottish Water  
Byelaws

UK Water Supply  
Regulations



## CL.1 Volume Control clockwise-closing 3/4" - Chrome

---

CL.1

36 608 705 Product version up to 10/14/2020

### Certificates and sustainability

---

WRAS\_2010

IAPMO\_4976 (

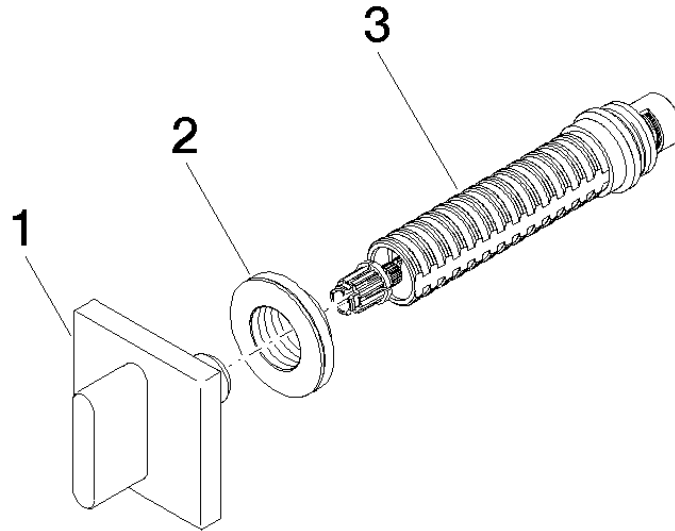

### Spare parts list

Number	Item Number	Designation	Number of units	Lead time
1	90 20 70 051 01-00	handle	1.00	10
2	09 21 02 108 90	disc	1.00	60
3	90 90 03 127 00 90	top	1.00	2