

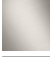



36 617 705 Product version up to 10/14/2020



- WAVE structure
- Flange 2-3/8" x 2-3/8"
- without marking
- Ceramic disc cartridge
(ADA)

(ADA)

	Chrome	36 617 705-00
	Brushed Platinum	36 617 705-06
	Dark Chrome	36 617 705-19
	Brushed Champagne (22kt Gold)	36 617 705-46
	Champagne (22kt Gold)	36 617 705-47
	Brushed Dark Platinum	36 617 705-99

Required article



- Rough for volume control 1/2" - 35 607 970-90 0010**
- Max. rough in depth 5-7/8"
 - Min. rough in depth 4-1/8"

36 617 705 Product version up to 10/14/2020

mm [inches]



Codes & Standards

ADA	ASME A112.18.1	cUPC	DIN 4109
EN 1111	EN 200	ISO 3822	Scottish Water Byelaws
UK Water Supply Regulations	Ü-Zeichen		

Certificates and sustainability

DVGW_DW-6501DN0	WRAS_2011	LGA_29	WRAS_2010	DVGW_DW-6512DN0
LGA_29	IAPMO_4976 (

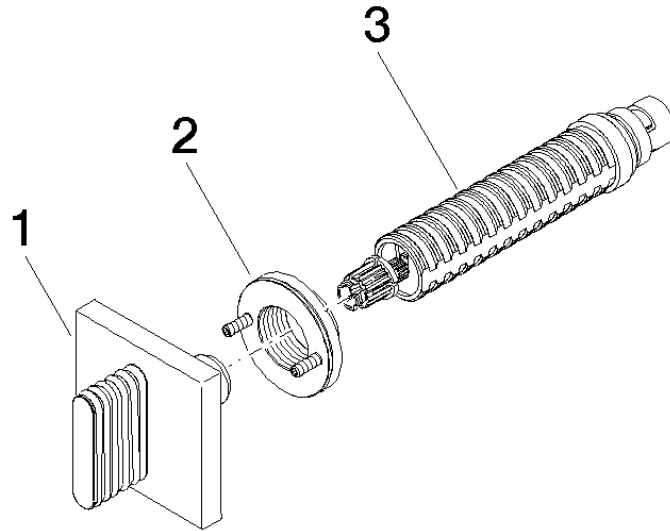

Spare parts list

Number	Item Number	Designation	Number of units	Lead time
3	90 90 03 143 00 90	top	1.00	2
1	90 20 70 055 01-00	handle	1.00	10
2	90 21 02 108 00 90	disc	1.00	2