

LIVING

Bowl washbasin, round



DIMENSIONS

Length	380 mm
Width	380 mm
Height	130 mm

COLOUR AND FINISH

<input type="checkbox"/>	000 White
--------------------------	-----------

OPTIONS

112 - without tap hole, without overflow

SPECIFICATION TEXT

Washbasin bowl LAUFEN LIVING SQUARE, SaphirKeramik, EN 31, dimensions d= 380 mm, round, without tap hole, without overflow, further options / accessories: Surface refinement LCC (only white), valve, without overflow, furniture, order no. 81143.5

Bowl length (mm) : 370

Bowl position : Central

Bowl width (mm) : 370

Fixing kit : Included

Installation type : Bowl / On countertop

Internal Shape : 1 - Round

Material : Saphirkeramik

Shape : Round

Tap hole configuration : No tap holes

Cradle to Cradle Certified®
 Cradle to Cradle Certified®: Product
 Circularity Bronze (Version 4.1)

TECHNICAL DRAWINGS

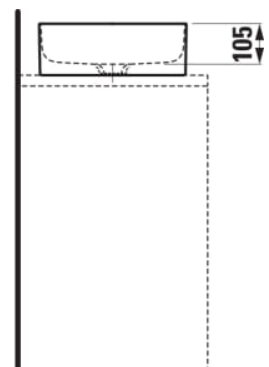
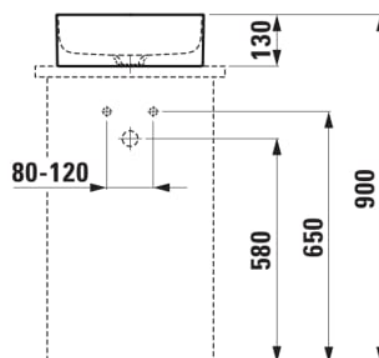
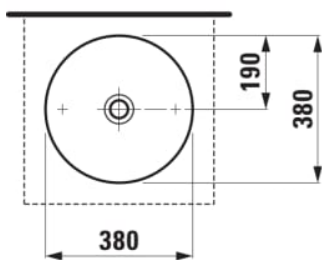

COMPATIBLE WITH



Countertop 800, with center cut-out, 80 mm thick, incl. 2 mounting brackets

H419101151...1



Countertop 800, with center cut-out, 80 mm thick, with tap cut-out, incl. 2 mounting brackets

H419105151...1



Countertop 1000, with center cut-out, 80 mm thick, incl. 2 mounting brackets

H419111151...1



Countertop 1000, with center cut-out, 80 mm thick, with tap cut-out, incl. 2 mounting brackets

H419115151...1



Countertop 1200, with center cut-out, 80 mm thick, incl. 2 mounting brackets

H419121151...1



Countertop 1200, with cut-out left, 80 mm thick, incl. 2 mounting brackets

H419122151...1



Countertop 1200, with cut-out right, 80 mm thick, incl. 2 mounting brackets

H419123151...1



Countertop 1200, with cut-out left and right, 80 mm thick, incl. 2 mounting brackets

H419124151...1



Countertop 1200, with center cut-out, 80 mm thick, with tap cut-out, incl. 2 mounting brackets

H419125151...1



Countertop 1200, with cut-out left, 80 mm thick, with tap cut-out, incl. 2 mounting brackets

H419126151...1



Countertop 1200, with cut-out right, 80 mm thick, with tap cut-out, incl. 2 mounting brackets

H419127151...1



Countertop 1200, with cut-out left and right, 80 mm thick, with tap cut-out, incl. 2 mounting brackets

H419129151...1



Countertop 1400, with center cut-out, 80 mm thick, incl. 3 mounting brackets

H419131151...1



Countertop 1400, with cut-out left, 80 mm thick, incl. 3 mounting brackets

H419132151...1



Countertop 1400, with cut-out right, 80 mm thick, incl. 3 mounting brackets

H419133151...1



Countertop 1400, with cut-out left and right, 80 mm thick, incl. 3 mounting brackets

H419134151...1



Countertop 1400, with center cut-out, 80 mm thick, with tap cut-out, incl. 3 mounting brackets

H419135151...1



Countertop 1400, with cut-out left, 80 mm thick, with tap cut-out, incl. 3 mounting brackets

H419136151...1



Countertop 1400, with cut-out right, 80 mm thick, with tap cut-out, incl. 3 mounting brackets

H419137151...1



Countertop 1400, with cut-out left and right, 80 mm thick, with tap cut-out, incl. 3 mounting brackets

H419139151...1



Countertop 1600, with center cut-out, 80 mm thick, incl. 3 mounting brackets

H419141151...1



Countertop 1600, with cut-out left, 80 mm thick, incl. 3 mounting brackets

H419142151...1



Countertop 1600, with cut-out right, 80 mm thick, incl. 3 mounting brackets

H419143151...1



Countertop 1600, with cut-out left and right, 80 mm thick, incl. 3 mounting brackets

H419144151...1



Countertop 1600, with center cut-out, 80 mm thick, with tap cut-out, incl. 3 mounting brackets

H419145151...1



Countertop 1600, with cut-out left, 80 mm thick, with tap cut-out, incl. 3 mounting brackets

H419146151...1



Countertop 1600, with cut-out right, 80 mm thick, with tap cut-out, incl. 3 mounting brackets

H419147151...1



Drawer element 800, 1 drawer, with center cut-out, Ardesia Bianca top

H414101151...1



Drawer element 800, 1 drawer, with center cut-out, Ardesia Bianca top with tap cut-out

H414105151...1



Drawer element 1000, 1 drawer, with center cut-out, Ardesia Bianca top

H414111151...1



Drawer element 1000, 1 drawer, with center cut-out, Ardesia Bianca top with tap cut-out

H414115151...1



Drawer element 1200, 1 drawer, with center cut-out, Ardesia Bianca top

H414121151...1



Drawer element 1200, 1 drawer, with cut-out left, Ardesia Bianca top

H414122151...1



Drawer element 1200, 1 drawer, with cut-out right, Ardesia Bianca top

H414123151...1



Drawer element 1200, 1 drawer, with cut-out left and right, Ardesia Bianca top

H414124151...1



Drawer element 1200, 1 drawer, with center cut-out, Ardesia Bianca top with tap cut-out

H414125151...1



Drawer element 1200, 1 drawer, with cut-out left, Ardesia Bianca top with tap cut-out

H414126151...1



Drawer element 1200, 1 drawer, with cut-out right, Ardesia Bianca top with tap cut-out

H414127151...1



Drawer element 1200, 1 drawer, with cut-out left and right, Ardesia Bianca top with tap cut-out

H414129151...1



Drawer element 1400, 2 drawers, with cut-out left, Ardesia Bianca top

H414132151...1



Drawer element 1400, 2 drawers, with cut-out right, Ardesia Bianca top

H414133151...1



Drawer element 1400, 2 drawers, with cut-out left and right, Ardesia Bianca top

H414134151...1



Drawer element 1400, 2 drawers, with cut-out left, Ardesia Bianca top with tap cut-out

H414136151...1



Drawer element 1400, 2 drawers, with cut-out right, Ardesia Bianca top with tap cut-out

H414137151...1



Drawer element 1400, 2 drawers, with cut-out left and right, Ardesia Bianca top with tap cut-out

H414139151...1



Drawer element 1600, 2 drawers, with cut-out left, Ardesia Bianca top

H414142151...1



Drawer element 1600, 2 drawers, with cut-out right, Ardesia Bianca top

H414143151...1



Drawer element 1600, 2 drawers, with cut-out left and right, Ardesia Bianca top

H414144151...1



Drawer element 1600, 2 drawers, with cut-out left, Ardesia Bianca top with tap cut-out

H414146151...1



Drawer element 1600, 2 drawers, with cut-out right, Ardesia Bianca top with tap cut-out

H414147151...1



Drawer element 1600, 2 drawers, with cut-out left and right, Ardesia Bianca top with tap cut-out

H414149151...1



Countertop 600, with centre cut-out, 65 mm thick, incl. 2 installation brackets

H404641112...1



Countertop 800, with centre cut-out, 65 mm thick, incl. 2 installation brackets

H404651112...1



Countertop 1000, with centre cut-out, 65 mm thick, incl. 2 installation brackets

H404661112...1



Countertop 1200, with center cut-out, 65 mm thick, incl. 2 installation brackets

H404671112...1



Countertop 1200, with cut-out left, 65 mm thick, incl. 2 installation brackets

H404672112...1



Countertop 1200, with cut-out right, 65 mm thick, incl. 2 installation brackets

H404673112...1



Countertop 1200, with cut-out left and right, 65 mm thick, incl. 2 installation brackets

H404674112...1



Countertop 1400, with centre cut-out, 65 mm thick, incl. 3 installation brackets

H404681112...1



Countertop 1400, with cut-out left, 65 mm thick, incl. 3 installation brackets

H404682112...1



Countertop 1400, with cut-out right, 65 mm thick, incl. 3 installation brackets

H404683112...1



Countertop 1400, with cut-out left and right, 65 mm thick, incl. 3 installation brackets

H404684112...1



Countertop 1600, with centre cut-out, 65 mm thick, incl. 3 installation brackets

H404691112...1



Countertop 1600, with cut-out left, 65 mm thick, incl. 3 installation brackets

H404692112...1



Countertop 1600, with cut-out right, 65 mm thick, incl. 3 installation brackets

H404693112...1



Countertop 1600, with cut-out left and right, 65 mm thick, incl. 3 installation brackets

H404694112...1



Drawer element 600, 2 drawers, with center cut-out, 12 mm top

H404301112...1



Drawer element 800, 2 drawers, with center cut-out, 12 mm top

H404311112...1



Modular 800, countertop 65 mm (.260 white matt), with centre cut-out, 2 drawers

H404551112...1



Modular 800, countertop 65 mm (.266 traffic grey), with centre cut-out, 2 drawers

H405551112...1



Modular 800, countertop 65 mm (.267 wild oak), with centre cut-out, 2 drawers

H406551112...1



Drawer element 1000, 2 drawers, with center cut-out, 12 mm top

H404321112...1



Modular 1000, countertop 65 mm (.260 white matt), with centre cut-out, 2 drawers

H404561112...1



Modular 1000, countertop 65 mm (.266 traffic grey), with centre cut-out, 2 drawers

H405561112...1



Modular 1000, countertop 65 mm (.267 wild oak), with centre cut-out, 2 drawers

H406561112...1



Drawer element 1200, 2 drawers, with center cut-out, 12 mm top

H404331112...1



Modular 1200, countertop 65 mm (.260 white matt), with centre cut-out, 2 drawers

H404571112...1



Modular 1200, countertop 65 mm (.260 white matt), with cut-out left, 2 drawers

H404572112...1



Modular 1200, countertop 65 mm (.260 white matt), with cut-out right, 2 drawers

H404573112...1



Modular 1200, countertop 65 mm (.266 traffic grey), with centre cut-out, 2 drawers

H405571112...1



Modular 1200, countertop 65 mm (.266 traffic grey), with cut-out left, 2 drawers

H405572112...1



Modular 1200, countertop 65 mm (.266 traffic grey), with cut-out right, 2 drawers

H405573112...1



Modular 1200, countertop 65 mm (.267 wild oak), with centre cut-out, 2 drawers

H406571112...1



Modular 1200, countertop 65 mm (.267 wild oak), with cut-out left, 2 drawers

H406572112...1



Modular 1200, countertop 65 mm (.267 wild oak), with cut-out right, 2 drawers

H406573112...1



Modular 1400, countertop 65 mm (.260 white matt), with cut-out left, 4 drawers: drawer element 800 left + drawer element 600 right

H404582112...1



Modular 1400, countertop 65 mm (.260 white matt), with cut-out right, 4 drawers: drawer element 800 right + drawer element 600 left

H404583112...1



Modular 1400, countertop 65 mm (.266 traffic grey), with cut-out left, 4 drawers: drawer element 800 left + drawer element 600 right

H405582112...1



Modular 1400, countertop 65 mm (.266 traffic grey), with cut-out right, 4 drawers: drawer element 800 right + drawer element 600 left

H405583112...1



Modular 1400, countertop 65 mm (.267 wild oak), with cut-out left, 4 drawers: drawer element 800 left + drawer element 600 right

H406582112...1



Modular 1400, countertop 65 mm (.267 wild oak), with cut-out right, 4 drawers: drawer element 800 right + drawer element 600 left

H406583112...1



Modular 1600, countertop 65 mm (.260 white matt), with cut-out left, 4 drawers: drawer element 800 right + drawer element 800 left

H404592112...1



Modular 1600, countertop 65 mm (.260 white matt), with cut-out right, 4 drawers: drawer element 800 right + drawer element 800 left

H404593112...1



Modular 1600, countertop 65 mm (.260 white matt), with cut-out left and right, 4 drawers: drawer element 800 right + drawer element 800 left

H404594112...1



Modular 1600, countertop 65 mm (.266 traffic grey), with cut-out left, 4 drawers: drawer element 800 right + drawer element 800 left

H405592112...1



Modular 1600, countertop 65 mm (.266 traffic grey), with cut-out right, 4 drawers: drawer element 800 right + drawer element 800 left

H405593112...1



Modular 1600, countertop 65 mm (.266 traffic grey), with cut-out left and right, 4 drawers: drawer element 800 right + drawer element 800 left

H405594112...1



Modular 1600, countertop 65 mm (.267 wild oak), with cut-out left, 4 drawers: drawer element 800 right + drawer element 800 left

H406592112...1



Modular 1600, countertop 65 mm (.267 wild oak), with cut-out right, 4 drawers: drawer element 800 right + drawer element 800 left

H406593112...1



Modular 1600, countertop 65 mm (.267 wild oak), with cut-out left and right, 4 drawers: drawer element 800 right + drawer element 800 left

H406594112...1



Open waste valve with SaphirKeramik cover

H898188...0001





LIVING

Reduction and individualism without excess: the formal design language of LIVING is created for those who appreciate contemporary spaces and design their surroundings with sensitivity and a deep sense of materiality. With pieces designed by Andreas Dimitriadis and Phoenix Design, the collection offers designers and architects the freedom to define the perfect wash area.



#material_text

saphirkeramik

Saphirkeramik

Saphirkeramik, patented and available on the market is one of the latest, globally significant innovation from LAUFEN. This revolutionary, ceramic material reaches its exceptional hardness blended with corundum, a colourless mineral, which is a component of sapphires. This gives Saphirkeramik a flexural strength equal to that of steel. Yet it has the potential to be wafer-thin, giving designers almost infinite freedom to experiment – and tear up the rulebook of bathroom design.